

G102 | G203 LIGHTSYNC

Gaming Mouse | 游戏鼠标
遊戲滑鼠 | 게이밍 마우스

SETUP GUIDE | 设置指南 | 設定指南 | 설치 가이드



logitech ™

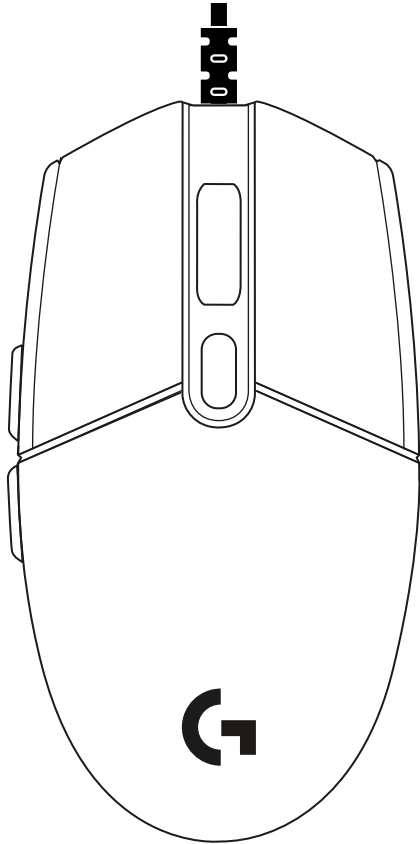

logitech 

Important Safety, Compliance and
Warranty Information
重要安全性、合規性和質保信息
重要安全性、合規性與保固資訊
중요 안전 규정, 준수 사항 및 보증 정보

ENGLISH	3
简体中文	6
繁體中文	9
한국어	12

SETUP INSTRUCTIONS

Please read the instructions before operating the product.

1 Plug mouse into USB port.

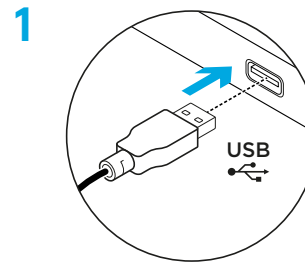

2 Download and install Logitech G HUB software from logitechG.com/GHUB.

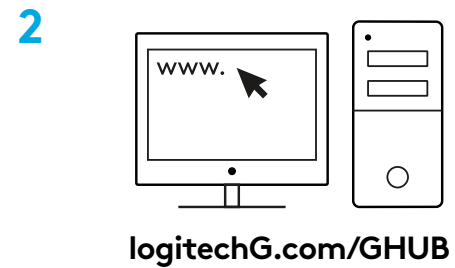

6 FULLY PROGRAMMABLE BUTTONS

By default these buttons are programmed:

- 1 Primary click
- 2 Secondary click
- 3 Wheel click
- 4 Forward
- 5 Back
- 6 DPI Cycle

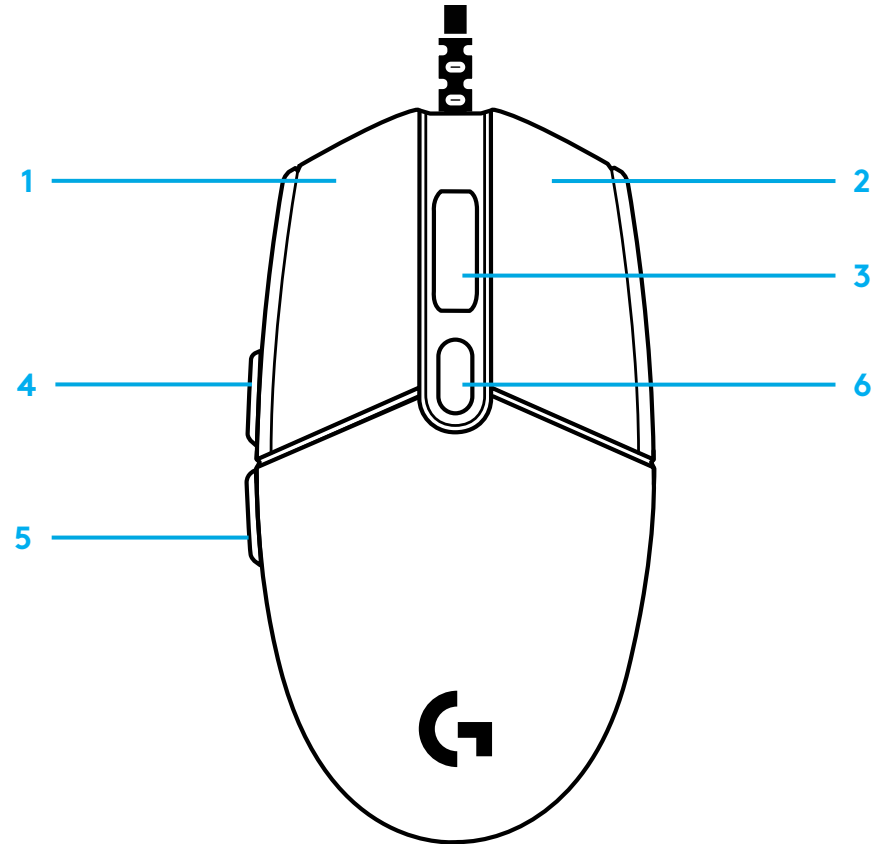

LIGHTSYNC RGB PROGRAMMABLE LIGHTING

G102 / G203 LIGHTSYNC has 3 independent lighting zones that can be customized using the Logitech G HUB software to a variety of solid colors or animated effects like a color cycle or breathing/pulsing.

Lighting can be synchronized with other supported Logitech G devices using the Logitech G HUB software.

Learn more: logitechG.com/GHUB



设置说明

请在操作产品前阅读说明书。

1 将鼠标插入 USB 端口。

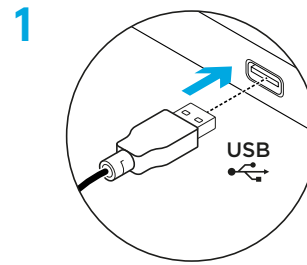

2 下载并安装罗技 G HUB 软件请访问 logitechG.com/GHUB。

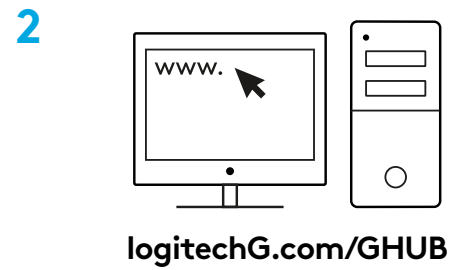

6 个完全可编程按钮

默认情况下这些按钮已被编程为:

- 1 主键
- 2 右键单击
- 3 滚轮点击
- 4 前进
- 5 后退
- 6 DPI 循环

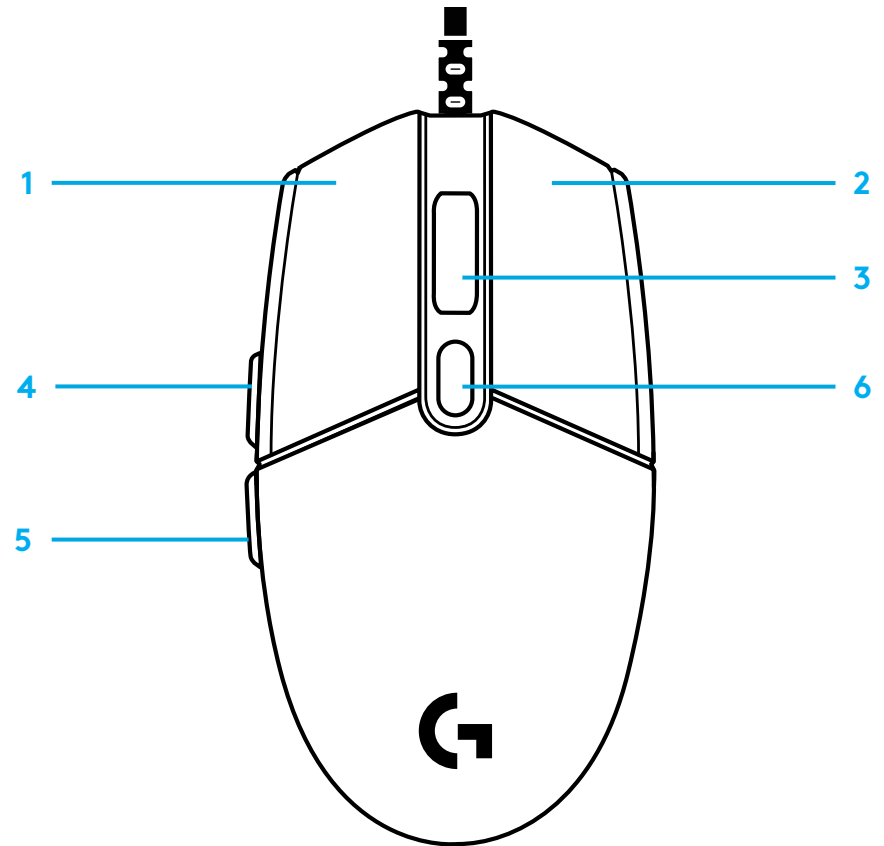

LIGHTSYNC RGB 可编程灯光

G102/G203 LIGHTSYNC 具有 3 个独立的灯光区域, 可以使用罗技 G HUB 软件进行自定义, 运用各种纯色或动画效果, 例如色彩循环或呼吸/脉动效果。

可以使用罗技 G HUB 软件将灯光与其他受支持的罗技 G 设备同步。

了解更多, 请访问: logitechG.com/GHUB



設定說明

操作此產品前請先閱讀指示說明。

1 將滑鼠插入 USB 連接埠。

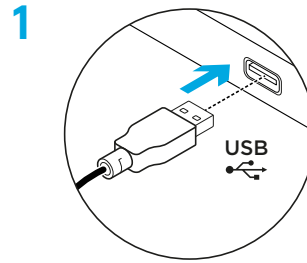

2 在下列網址下載並安裝羅技 G HUB 軟體：logitechG.com/GHUB。

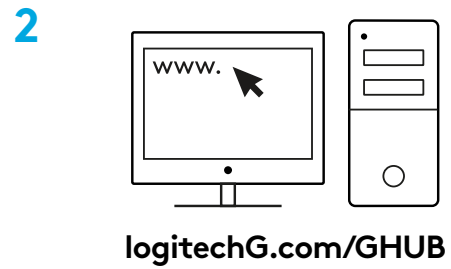

6 個可完全自訂的按鈕

在預設情況下，這些按鈕是設定為：

- 1 主要點按
- 2 次要點按
- 3 點按滾輪
- 4 前進
- 5 後退
- 6 DPI 循環切換

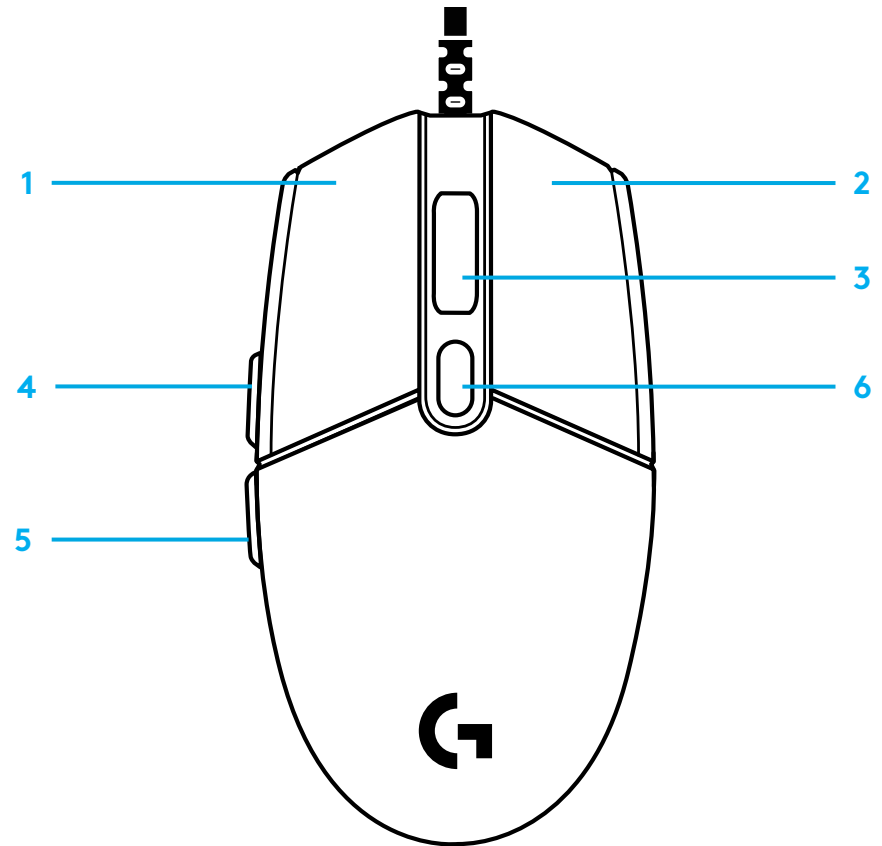

LIGHTSYNC RGB 可自訂背光

G102 / G203 LIGHTSYNC 有 3 個獨立的背光區域，可以使用羅技 G HUB 軟體自訂為不同色彩或動畫效果，例如色圈或呼吸/閃爍效果。

使用羅技 G HUB 軟體，可以將背光設定同步到其他支援的羅技 G 系列裝置。

瞭解更多資訊：logitechG.com/GHUB

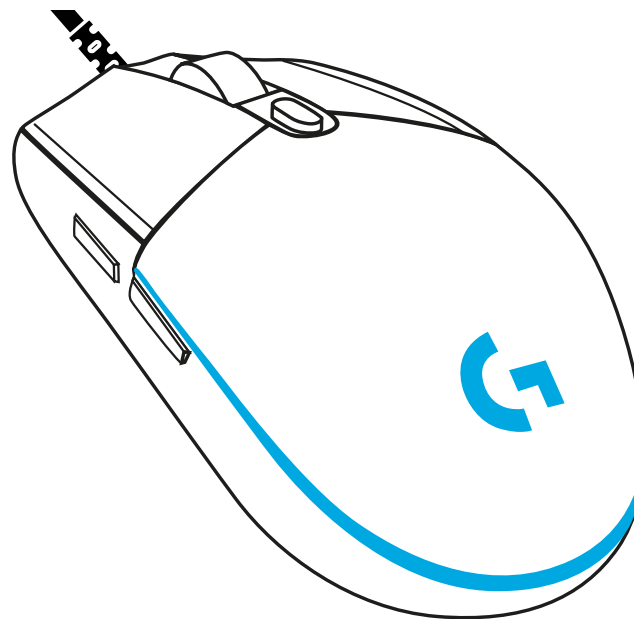

설치 지침

제품을 사용하기 전에 지침을 읽으십시오.

1 마우스를 USB 포트에 연결하십시오.

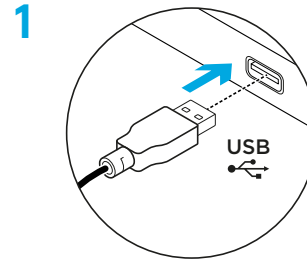

2 로지텍 G HUB 소프트웨어를 logitechG.com/GHUB에서 다운로드하여 설치하십시오.

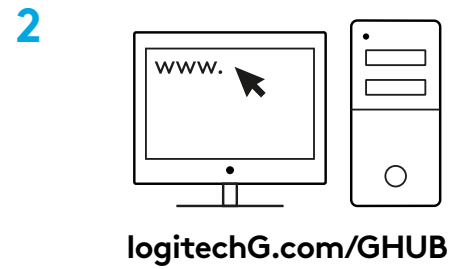

6개의 프로그래밍 가능한 버튼

기본적으로 프로그래밍된 버튼:

- 1 기본 클릭
- 2 보조 클릭
- 3 휠 클릭
- 4 앞으로
- 5 뒤로
- 6 DPI 주기

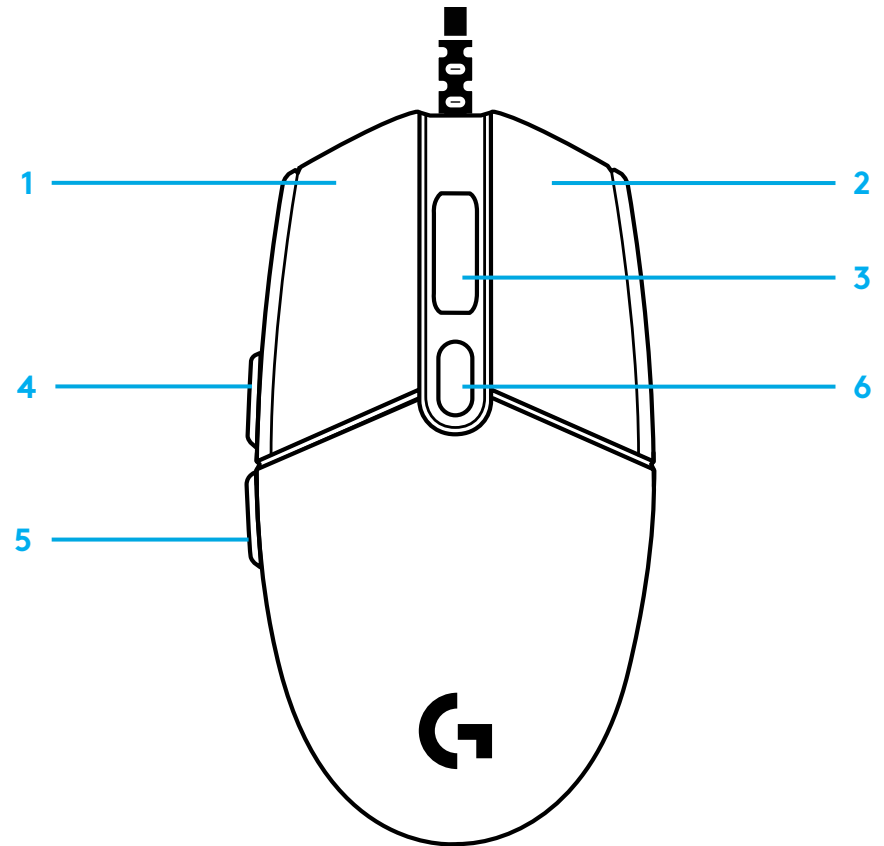

LIGHTSYNC RGB 프로그래밍 가능한 조명

G102 / G203 LIGHTSYNC에는 3개의 독립된 조명 영역이 있으며 로지텍 G HUB 소프트웨어를 사용하여 색 순환 또는 브리딩/펼상과 같은 다양한 색상 또는 애니메이션 효과를 커스터마이징할 수 있습니다.

로지텍 G HUB 소프트웨어를 사용하여 지원되는 다른 로지텍 G 기기와 조명을 동기화할 수 있습니다.

자세한 정보: logitechG.com/GHUB





©2020 Logitech. Logitech, Logitech G, Logi, 罗技, 罗技G and their respective logos are trademarks or registered trademarks of Logitech Europe S.A. and/or its affiliates in the U.S. and other countries. All other trademarks are the property of their respective owners. Logitech assumes no responsibility for any errors that may appear in this manual. Information contained herein is subject to change without notice.

版权所有 ©2020 Logitech。罗技、罗技 G、Logi、Logitech、Logitech G 及其各自标志为 Logitech Europe S.A. 和/或其在美国及其他国家附属公司的商标，并或已注册。所有其他商标均是其各自所有者的财产。罗技对于本手册中可能出现的任何错误不承担任何责任。本手册中包含的信息如有更改，恕不事先通知。

WEB-621-001683.002